

INSTALLATION INSTRUCTIONS

DESCRIPTION: Rear Carrier Kit
 PART # B4C-F48D0-V0
 MODEL: '18~ MT-07



⚠ WARNING

Please read and understand these instructions completely before installation to avoid possible injury to yourself, or damage to the accessory or vehicle.

NOTICES:

This installation requires a torque wrench and should be performed by an authorized Yamaha dealer or other qualified technician.

WARRANTY INFORMATION:

In the United States, see your Yamaha dealer for a copy of the Genuine Yamaha Accessories Limited Warranty Statement.

DEALER:

Please give a copy of these instructions to your customer as they contain important information for future reference.

PARTS LIST:

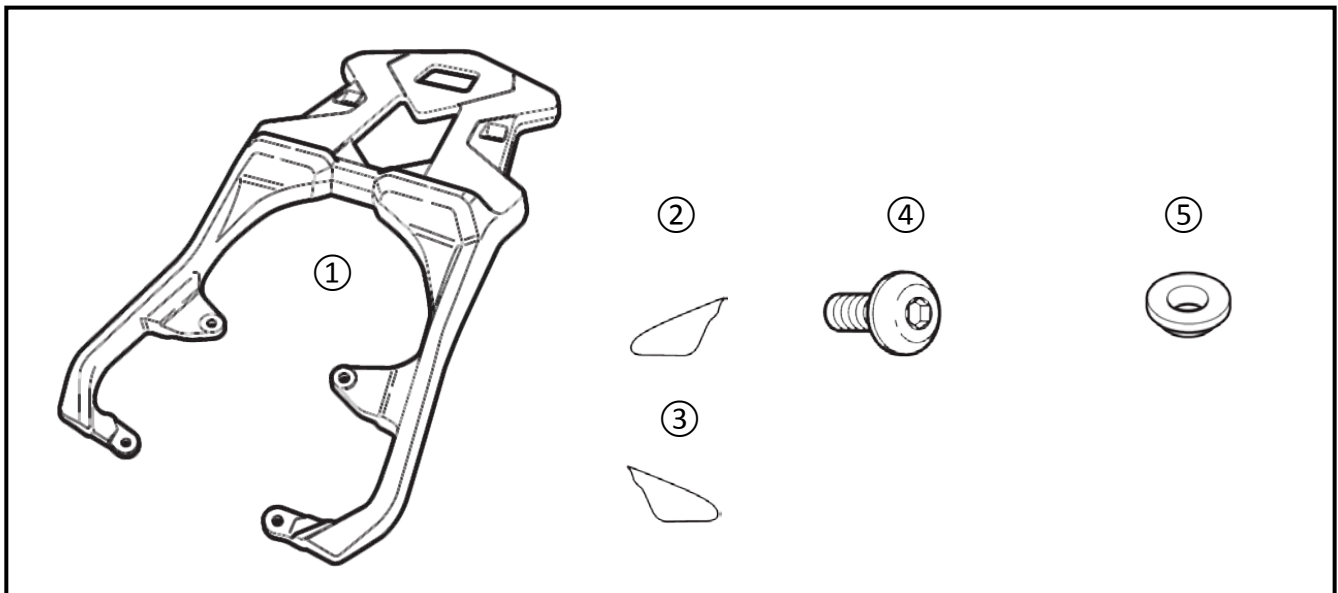

No.	Part Number	Description	Qty
--	B4C-F48D0-V0	Rear Carrier Kit	--
①	*	Rear Carrier	1
②	*	Bolt Cover, Left	1
③	*	Bolt Cover, Right	1
④	*	M8x25mm Hex Button Head Bolt	4
⑤	*	Collar	4

*Part supplied with kit only and not available separately.



PREPARATION:

- Stand the motorcycle on a secure and level surface.
- Clean all mounting surfaces before beginning installation.

Fig. 1

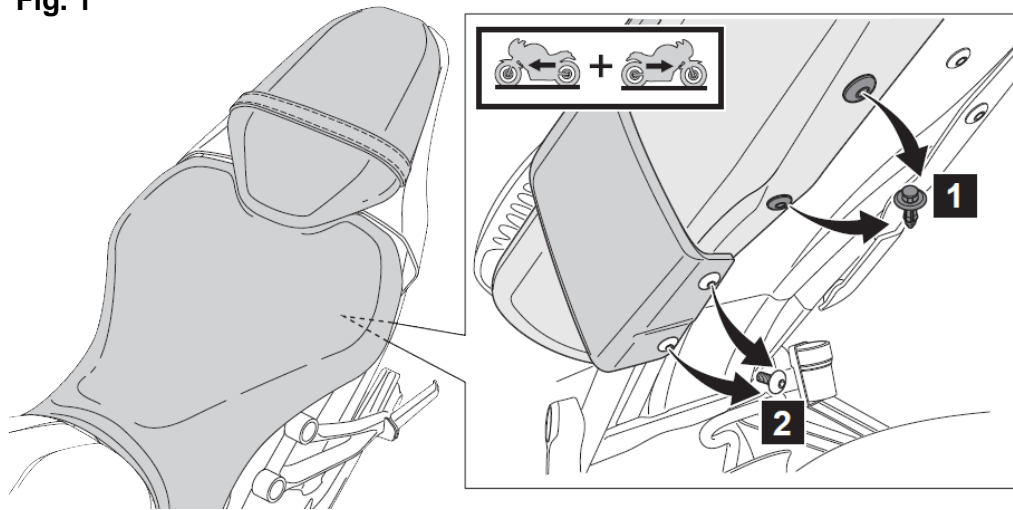

Fig. 2

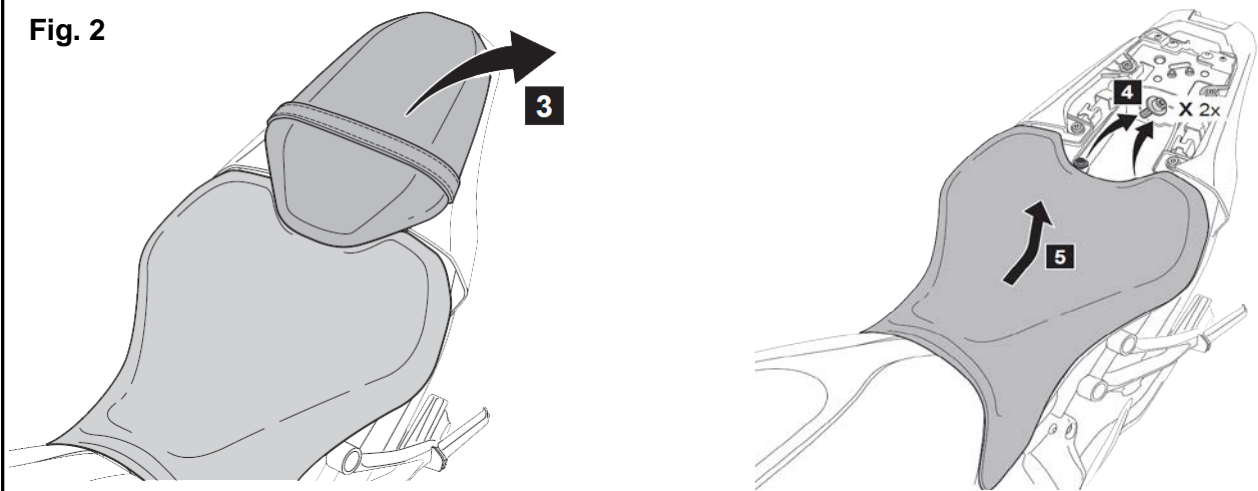
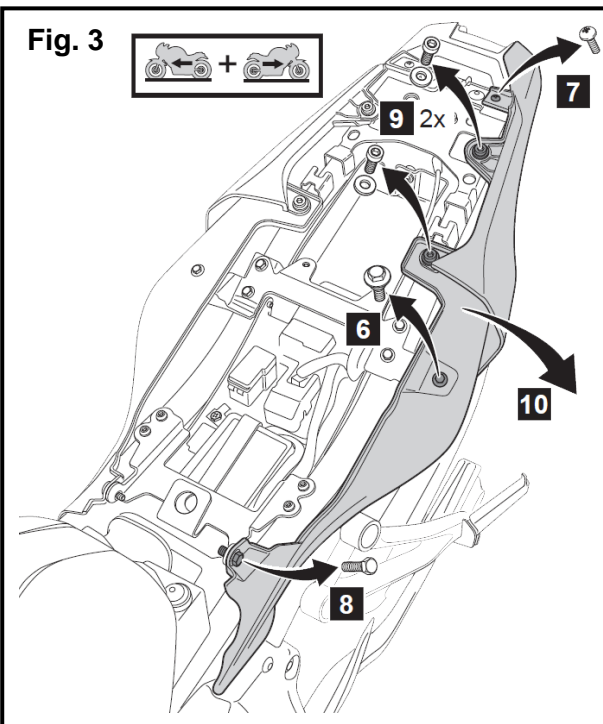
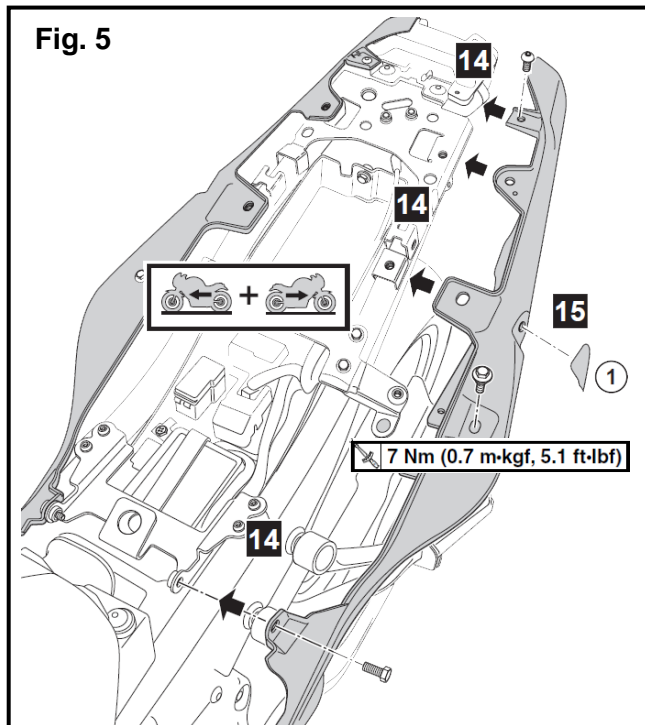
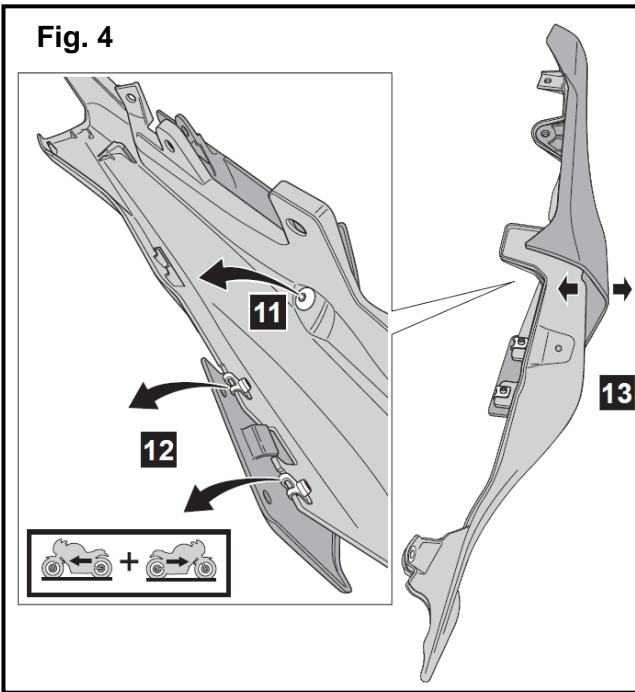

Fig. 3



INSTALLATION:

1. Starting on the left side, under the seat – remove two plastic rivets **1** and two bolts **2**. Retain for reuse. See Fig. 1.
2. Remove the passenger seat **3** and remove the **5** riders seat by removing the **4** two stock bolts as shown in Fig. 2. Retain bolts for reuse.
3. From the top, remove the bolts and washers that secure the rear fairing **6**, **7**, **8**, **9** as shown in Fig. 3. The two bolts and washers near the **9** in Fig.3 are not reused. Retain all other hardware for reuse. Remove the fairing from the bike **10**.



4. From underneath, remove bolt **11** and two clip nuts **12**. Retain hardware for reuse. Remove rear fairings and separate the outer and inner fairing **13**. The outer fairing (shown in darker gray in Fig. 4) is not reused in this installation. Store this part for reinstallation should you wish to return the bike to stock.
5. Fit the rear fairing back onto the bike and use three stock bolts to secure the rear fairing **14**. Torque these bolts to 7Nm (5.1 lb-ft). Press the **2** Bolt Cover, Left into place **15** as shown in Fig. 5.
6. Repeat steps 1 - 5 on the right side.
7. Install four **5** Collars to the mount points used by the rear carrier as shown in Fig. 6.
8. Set the **1** Rear Carrier in place on the rear subframe and thread four **4** M8x25mm Hex Button Bolts through the Rear Carrier, Collars, and into the frame.
8. Torque bolts to **16** 20 Nm (14.8 ft-lbf).

MAINTENANCE:

Periodically check all hardware for tightness and re-torque as necessary.

CARE AND CLEANING:

Wash using a mild soap and water solution and soft cloth.

CUSTOMER SERVICE:

For further information see your Yamaha dealer.

ESTIMATED TIME TO INSTALL: 1.2 HRS

